



YOUR
ENTRY
EXPERTS.

TOURNIKET.

THE **AUTOMATIC OR MANUAL** ORIGINAL REVOLVING DOOR

The Tourniket was the first revolving door we manufactured; created in 1903, the Tourniket was originally constructed mainly from timber and had to be operated manually. Since then its construction and the technology within have evolved into a sophisticated and intelligent revolving door. This automatic or manual revolving door is still at the basis of many of the special projects we are involved in as it is an incredibly versatile entry solution. Its engineering quality has been proven again and again in many different buildings and projects.

**CLICKABLE.**

Make the most of your experience within this brochure, and hover your mouse over words and pictures to get deeper insights and inspiration. (pdf version only)

OVERVIEW

The Tourniket is our most versatile revolving door that can be fully customised to reflect your building's design and functionality. It is available with three or four door wings, with manual or automatic operation and in virtually any colour or finish you can think of.

The Tourniket is also available with a door set that can automatically fold open when the disabled access button is pushed. This feature allows easy, unhindered disabled access even in small diameter doors.

A SUSTAINABLE SOLUTION

Revolving doors are the most energy-efficient entrance solutions available today. The always open, always closed principle of a revolving door ensures that the conditioned inside air and the unconditioned outside air remain separated, preventing draught, dust and noise from coming into the building. As less energy is required to maintain the conditioned climate inside the building, revolving doors help reduce the carbon footprint of a building and save both energy and cost.

The same effect can be reached by installing a draught lobby but for draught lobbies with conventional sliding or swinging doors to be truly effective, the entrance and exit doors of the lobby can never be open at the same time. This means that users are often required to wait in the draught lobby for the next door to open, causing frustration and a feeling of being unwelcome. The advantage of revolving doors is that they save energy while facilitating a continuous flow of people.

SAFETY AND SECURITY ARE IMPORTANT

Security in an entry has two different aspects: the security of the building and the safety of its users. The Tourniket complies with the strictest safety regulations.

Safety Sensors in the door wings and in the frame ensure that the door responds to users and objects, minimising, or even preventing, impact with the user. The door behaviour can be customised to suit your building's requirements. Such requirements could be based on your priority for safety or throughput taking into account various user groups ranging from professionally trained users to locations where people with special needs form a large part of the user profile such as children and elderly people.

We offer the following additional safety measures:

- Accessibility buttons
- Visual signage on the door wings and curved walls to ensure the accessibility of our doors for all user groups.
- CE plus package

The front entrance to a public building, such as a hotel, office building, condominium, or municipal building should also include security options. Whether there is an unwanted guest immediately outside the door, or the facility manager is locking up for the night, revolving door security options allow for an added layer of protection.

We offer the following additional security measures:

- RC3 Burglar protection package
- Automated or manual locking options
- External or internal night-locking doors
- Security lockdown
- Remote locking
- Access control options

ESCAPE ROUTE

The escape route is one of the main issues when considering the main entrance to a building. The Tourniket is available with an option of a collapsible door set on both the three and four-wing models.

If equipped with a collapsible door set, the Tourniket can be installed in an escape route. In case of an emergency, the door set will unlock and the door wings can be folded together to create an open passageway. Please note that the minimum passage widths are subject to local regulations and building specifications.

ACCESSIBILITY

Some of the larger 3-wing versions of the Tourniket cater for disabled access. Alternatively, the Autofolding Tourniket is designed specifically for those situations where disabled access is required in a small lobby or entry. It is available in diameters starting from 2800 mm. What makes the Autofolding Tourniket unique is the door set that can fold itself automatically to create a completely free passage for wheelchairs and trolleys.

KEY FEATURES

- 3 or 4-Wing configuration
- Manual, semi-automatic or fully automatic operation
- Low energy assisting and positioning
- Speed control
- Large selection of dimensions
- Rigid, collapsible or automatic folding door set

PUT YOUR STAMP ON IT

The Tourniket is available in a variety of finish and colour options. In many buildings a powder-coated aluminium version is chosen which can be finished in virtually any colour, ranging from traditional RAL colours to the deep-matt finishes resembling anodizing, yet in an eco-friendly manner. The wooden Tourniket takes you back to the early history of the revolving door and gives a classic retro look while a stainless steel or mirror finished look can create a modern or even futuristic look. This door is a particular favourite of ours.

Our revolving doors are available in a wide variety of heights and widths with different canopy heights and heights under canopy, ensuring that many design wishes can be solved with one of our standardised products. If your design falls outside the options that are available, our sales managers and engineers will work with you to create a safe and sustainable entrance that meets all requirements.

KEY BENEFITS

- Handles low to moderate throughput
- Access for all (easy, convenient disabled support)
- Automatic operation for touchless entry
- Sustainable and energy-saving
- Reduced air infiltration
- Good ROI
- Highly customisable (extend your brand)

SUGGESTED SEGMENTS

- Corporate
- Governmental
- Retail
- Restaurants and hospitality
- Airports
- Hospitals
- Hotels

You can level up in any of these categories:

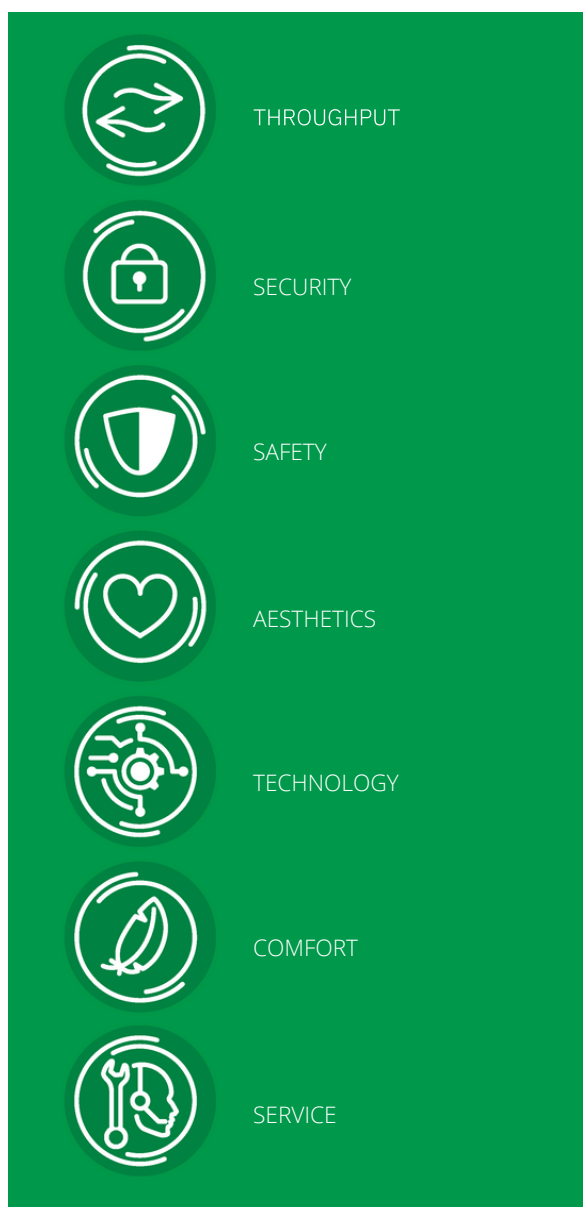

LEVEL UP

If our standard specifications do not quite suit your needs, we open up opportunities for you to 'Level Up' where it counts most. You can also do this according to your most motivating value driver:

The specification table shows you our standard product options, and to the right of these, you can easily see, and consider, any compatible 'Level Up' options for fine-tuning the Tourniket.



A: 4-Wing rigid model (most popular)
B: 3-Wing rigid model

TECHNICAL SPECIFICATIONS

 THROUGHPUT	MOST POPULAR	VARIATIONS
Throughput	2 x 22 People per minute	2 x 18 - 2 x 46 People per minute
Diameter	3000 mm	Available as standard in any diameter between 1600 - 3800 mm
Height Under Canopy	2200 mm	Available as standard between 2100 - 3600 mm
Canopy Height	300 mm	Available as standard between 200 - 1200 mm
Throat Opening	2036 mm	Available as standard between 695 - 2601 mm
Number of Doors / Wings	4	3
 SECURITY	MOST POPULAR	VARIATIONS
Night-locking	Manual-locking door set	External or internal night-locking doors automatic locking
Controllable Locking	-	Security lockdown Secured access out-of-hours
Protection Level	Vandal resistant safety glass (P2A)	RC3 Burglar protection package
 SAFETY	MOST POPULAR	VARIATIONS
Safety Packages	CE Basic	CE Plus / DIN 18650 / UKCA / ANSI / Chinese standard
Drive Unit	Drive with speed control and block detection	BoonAssist (low-energy drive) with speed control
Escape Route	-	Collapsible door set with activation button
Fire Alarm	Connection prepared in control system	-
 AESTHETICS	MOST POPULAR	VARIATIONS
Finish	Powder coated aluminium	Anodic coated aluminium Stainless steel cladding brushed / mirror
Glass	Glass decals	Tinted and low iron glass options
Canopy	Extruded solid canopy	Glass roof 18 mm Canopy cover material options
Ceiling	Coordinated colour, material and finish	Alternative colour, material and finish
Door Handles	-	Vertical Ø40 mm
Floor Mat and Trim	Floor mounted	Matwell trim Floor mat
 TECHNOLOGY	MOST POPULAR	VARIATIONS
Drive	Drive unit in canopy	Manual operated BoonAssist (low-energy drive) Drive unit in or under floor
Door Control	Control panel on door	Control panel external Door connected to BMS
 COMFORT	MOST POPULAR	VARIATIONS
Accessibility	-	Push-button temporary low speed Autofolding door set for barrier friendly entrance
Lighting and Sound	LED's 4	LED's 6 or custom LED's / lighting Voice module
Climate Control	Genuine horse hair brushes with EPDM interlayer	Air curtain options
Activation	Direction-sensitive motion sensors Welcome mode - idle speed	Push & Go BoonAssist with assist and positioning Convenient out-of-hours entry

For more variations, to suit your project even further, please contact your entry expert.

6 WORKING PRINCIPLE - STANDARD

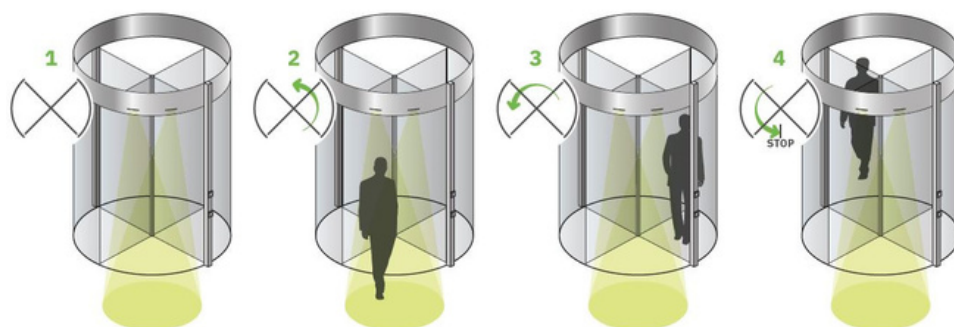

WORKING PRINCIPLE - COLLAPSIBLE DOOR SET

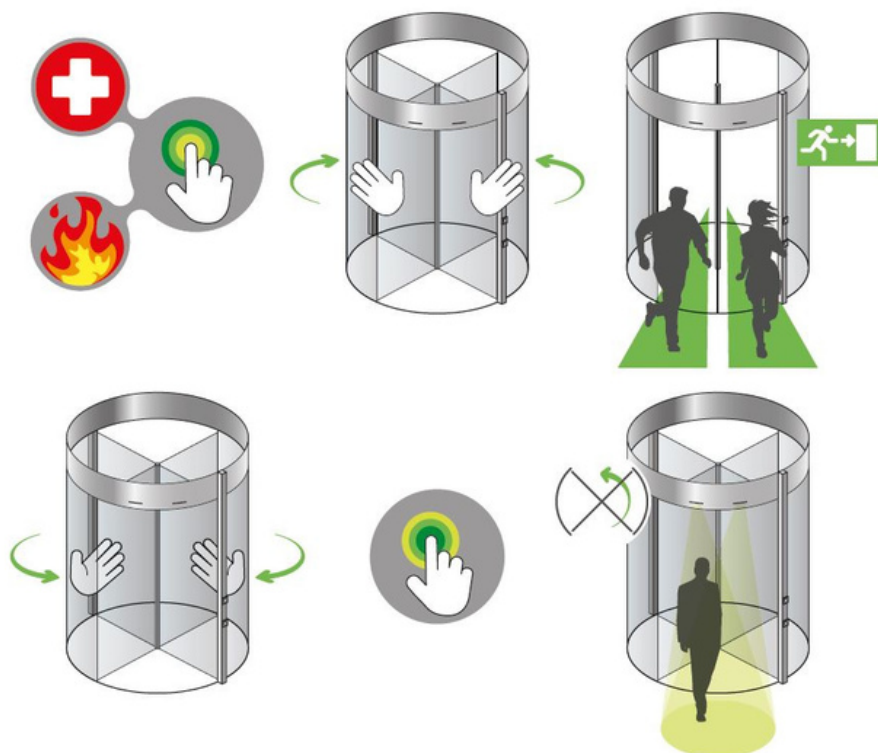

TECHNICAL DIMENSIONS

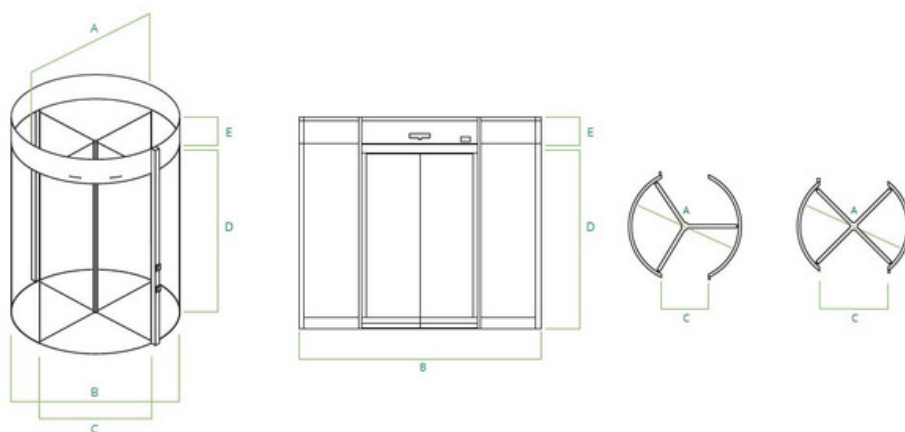

- A. Diameter
- B. Installation Width (mm)
- C. Throat Opening (mm)
- D. Height Under Canopy (mm)
- E. Canopy Height (mm)



SERVICE AND MAINTENANCE

With hundreds of thousands of visitors passing through an entry every day, continued and reliable operation is vital. Regular service and maintenance can prevent unexpected hardware breakdowns. Boon Edam's service and maintenance teams across the world are experienced in the effects the local conditions have on the wear and tear of your entry solutions and can offer specialised service and maintenance contracts that correspond to those conditions perfectly.

COMPLIANCE

Boon Edam entrances are trusted solutions that allow organisations to meet compliance regulations related to restricting access to areas within a building. We take compliance and safety very seriously and ensure that our products are manufactured, installed and maintained to keep up with the strict criteria required in all our countries. We are always improving and committed to making sure our products are compliant and certified. More information can be found on our website under 'About Us'.

The Tourniket complies with the following European standards:

- Machine Directive 2006/42/EC
- EMC Directive 2014/30/EC
- RoHS Directive 2011/65/EU
- EN16005 2012 - Safety in use - Requirements and test methods
- EN1627 – Burglar-resistant package
- EN356 – Glass specification



OUR REACH IS GLOBAL.

We have been in business for more than 140 years manufacturing premium aesthetic and security entrance solutions in the Netherlands, United States of America and China. We can confidently say that we cover every corner of the globe with subsidiary companies in major cities across the globe. Furthermore our global export division not only partner with our distributors, but also offer direct sales and service to every territory. This wide net allows us to have a strong global footprint as well as a personal grasp of local markets and their unique entry requirements.

To find your closest Boon Edam expert, please go to:
www.boonedam.com.au/contact



Boon Edam Australia Pty Limited

T 1300 689 905

E info@boonedam.com.au

I www.boonedam.com.au

BOON EDAM
YOUR **ENTRY** EXPERTS.